

The BARE FOOT Cabin



House Features

- 2 Bedrooms
- 2 Bathrooms
- Loft Living Area

Heated SqFt

- Main Level - 704
- Upper Level - 490

Total

1194

UnHeated SqFt

- Front Porch - 192

Pictured With

- 12" Concrete D-Log
- Butt-n-Pass Corners
- Shade Siding (Gables)
- 8" Sq Porch Posts
- Wood Picket Railing

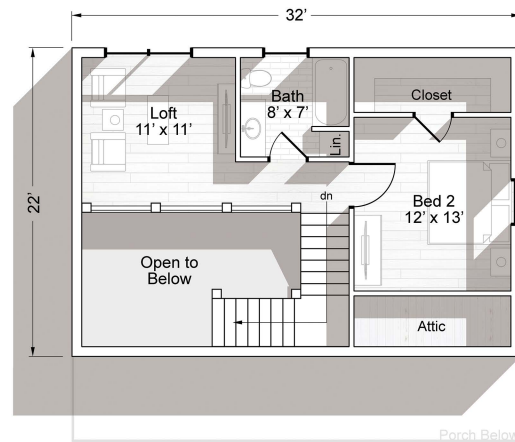
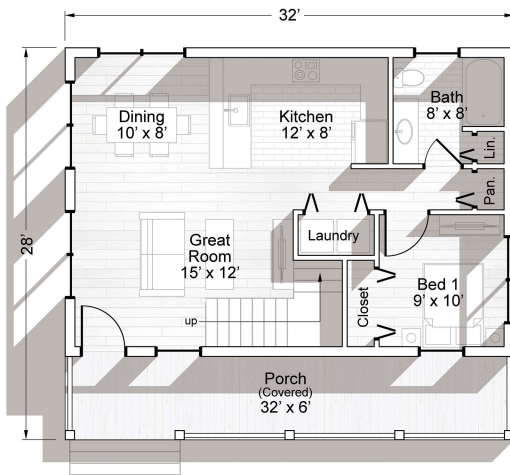

Front Elevation



Left Elevation



Rear Elevation



Right Elevation



865-366-1235
TRBCustomHomes.com